



## Model TBX

### Specifications

Model	TBX30	TBX100	TBX100F	TBX150F
Flow-rate range (m <sup>3</sup> /h)	4-30	10-100	10-100	12.5-150
Max. working pressure(kPa)	100kPa (Approx. 1.0kgf/cm <sup>2</sup> )			
Accuracy	Flow measurement section	±1%FS		
	Arithmetic display section	-		
Display	Integrated flow	LCD 8 digits, Minimum reading 10 liters		LCD 8 digits, Minimum reading 100 liters
	Trip	LCD 6 digits, Minimum reading 10 liters		LCD 6 digits, Minimum reading 100 liters
	Instantaneous	LCD 4 digits, Minimum reading 0.1m <sup>3</sup> /h		LCD 3 digits, Minimum reading 1m <sup>3</sup> /h
	Temperature	-		
	Pressure	-		
Temperature/pressure compensation	-			
Connection	Rc1 1/2, Rc1 1/4	Rc2	2B Flange(JIS10K)	
Applicable temperature	0 to 60°C			-10 to 60°C
Installation position	Horizontal, Vertical			
Measurable gases	* Natural gas, LPG, Air, etc.			
Battery	Built-in lithium battery with a life of 7 years (Approx)			
Output pulse	2-systems open collector output (Unit pulse, high density)			
Installation	Indoor			
Casing material	Aluminum alloy		Cast iron	Aluminum alloy
Weight (kg)	0.8	1.8	7.0	2.5

\* Please avoid installing the meter in a place where carbonate substance (C5 or above) from LPG or City Gas, oil mist, and/or dust powder, etc., waft.

\* Please indicate flow direction when ordering (LEFT to RIGHT or RIGHT to LEFT).

## External Dimensions

TBX 30/100

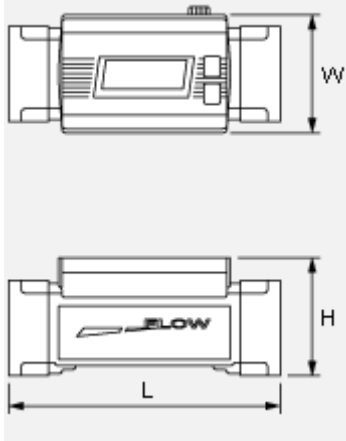

TBX 100F/150F

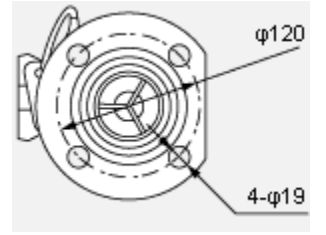
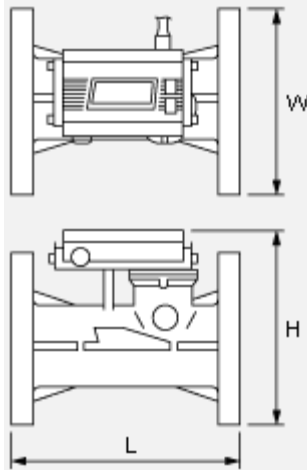

(Units : mm)

	L	H	W
TBX30	170	74	73
TBX100	200	100	85
TBX100F	200	161	$\Phi 155$
TBX150	200	148	$\Phi 155$